

## **RETAIL SPACE AVAILABLE NOW**

40-62 Central Street Georgetown, Massachusetts 01833

Conveniently located in the center of Georgetown, Georgetown Crossing is anchored by Crosby's Marketplace, TD Bank and is home to seven additional businesses. The tenant mix includes beauty, fitness, and dry goods and dry-cleaning providers, along with Pomodori Roast Beef and Pizza for family-friendly dining. Georgetown Crossing is easily accessed from Route 95 via Routes 97 and 133 into downtown Georgetown.

# Georgetown Crossing

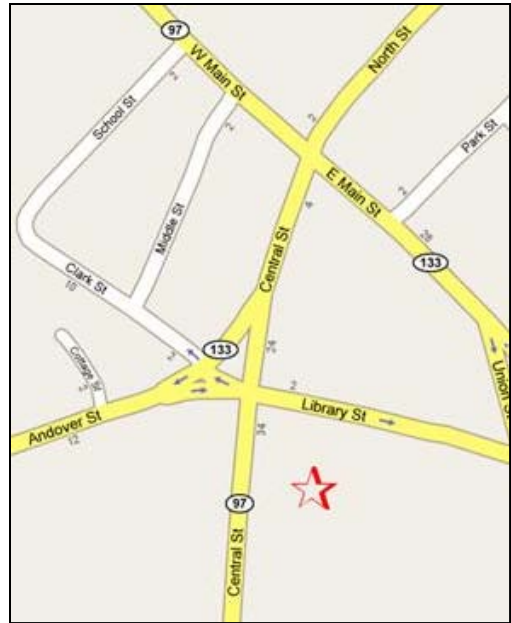
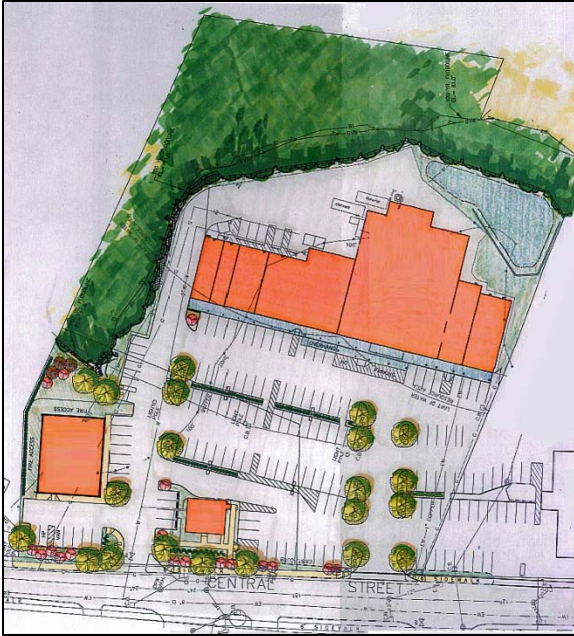

Located on Central Street (Route 97), just one block south of Route 133, the Shopping Center sees an average daily traffic count of over 19,000 vehicles. This highly visible, well established 31,200 square foot shopping destination was completely redesigned in 2004 with a New England village motif and fits in nicely with the historic character of Georgetown. The property offers ample and well-lit parking with beautiful landscaping.

For more information or to view the property, please contact  
**Susan Brown at 617-435-0661 • [sbrown@liscodevelopment.com](mailto:sbrown@liscodevelopment.com)**  
Or, contact LISCO Development, Inc. at 888-766-0425.

**LISCO DEVELOPMENT, Inc 12 Bassett Street Providence, RI 02903 (401) 621-4007**  
**Massachusetts:** The Shoppes at Hamilton Crossing, Ipswich Crossing,  
Georgetown Crossing & Atlantic Avenue, Marblehead

**Rhode Island:** Riverside Plaza Shopping Center,  
Regency Plaza Apartments, Bay View Estates Apartments